

I. DENOMINATION OF THE EVENT

Venue: Vejer de la Frontera - Autumn Tour Dehesa Montenmedio 2020

Date: 21st - 23rd November (W5) **NF:** ESP

Indoor:

Outdoor:

EVENT CATEGORIES:

- | | | | | |
|---------------------------------|----------------------------------|---|-----------------------------------|-----------------------------------|
| CSIO5* <input type="checkbox"/> | CSI5*-W <input type="checkbox"/> | CSI5* <input type="checkbox"/> | CSIU25-A <input type="checkbox"/> | CSIU25-B <input type="checkbox"/> |
| CSIO4* <input type="checkbox"/> | CSI4*-W <input type="checkbox"/> | CSI4* <input type="checkbox"/> | CSIY-A <input type="checkbox"/> | CSIY-B <input type="checkbox"/> |
| CSIO3* <input type="checkbox"/> | CSI3*-W <input type="checkbox"/> | CSI3* <input checked="" type="checkbox"/> | CSIJ-A <input type="checkbox"/> | CSIJ-B <input type="checkbox"/> |
| CSIO2* <input type="checkbox"/> | CSI2*-W <input type="checkbox"/> | CSI2* <input type="checkbox"/> | CSIch-A <input type="checkbox"/> | CSIch-B <input type="checkbox"/> |
| CSIO1* <input type="checkbox"/> | CSI1*-W <input type="checkbox"/> | CSI1* <input type="checkbox"/> | CSIV-A <input type="checkbox"/> | CSIV-B <input type="checkbox"/> |
| CSIOY <input type="checkbox"/> | | CSIL1* <input type="checkbox"/> | CSIAm-A <input type="checkbox"/> | CSIAm-B <input type="checkbox"/> |
| CSIOJ <input type="checkbox"/> | | CSIYH2* <input type="checkbox"/> | CSIP <input type="checkbox"/> | |
| CSIOPI <input type="checkbox"/> | | CSIYH1* <input checked="" type="checkbox"/> | | |
| CSIOCh <input type="checkbox"/> | | | | |

Championship

Games

II. GENERAL CONDITIONS

- FEI Statutes, 24th edition, effective 19 November 2019
- FEI General Regulations, 24th edition, 1st January 2020
- FEI Veterinary Regulations, 14th edition, 1 January 2018, updates effective 1st January 2020
- The Jumping Rules and its Annexes, 26th edition, updates effective 1 January 2020
- <https://inside.fei.org/fei/regulations/jumping>
- CSI/CSIO Prize Money requirements 2020
<https://inside.fei.org/sites/default/files/Final%20CSIs-CSIOs%20-%202020.pdf>
- Longines Rankings – Groups Categories 2020
<https://inside.fei.org/sites/default/files/Final%20Longines%20Ranking%20Groups%20-%202020.pdf>
- Equine Anti-Doping and Controlled Medication Regulations (EADCMR), 2nd Edition, effective 1 January 2015, updates effective 1st January 2020
- FEI Anti-Doping Rules for Human Athletes (ADRHA), based upon 2015 WADA Code, effective 1 January 2015
- All subsequent published revisions/updates, the provisions of which will take precedence.

THE ANNEXE(S) IS/ARE PART OF THIS APPROVED AND SIGNED SCHEDULE AND MUST BE DISTRIBUTED TO ALL OFFICIALS AND NFs AND IS AVAILABLE TO OTHERS UPON REQUEST

Approved by the FEI, Lausanne, on 26/10/2020. Updated on 06/11/2020.

Deborah Riplinger
 Interim Jumping Director

NB: No modifications to the approved Schedule will be accepted less than two weeks prior to the event. Additionally, no change may be made to a Longines Ranking competition once the schedule has been approved. Prizes in kind, to be accepted as prize money to count for Longines Ranking competitions and total event prize money, must be easily convertible into cash (GRs Art. 127).

TABLE OF CONTENTS

I.	DENOMINATION OF THE EVENT	1
II.	GENERAL CONDITIONS	1
III.	THE FEI CODE OF CONDUCT FOR THE WELFARE OF THE HORSE	3
IV.	GENERAL INFORMATION	4
1.	ORGANISER	4
2.	ORGANISING COMMITTEE	4
3.	EVENT DIRECTOR	4
4.	STABLE MANAGER.....	5
5.	ANNOUNCER	5
V.	OFFICIALS	6
VI.	INVITATIONS	7
1.	GENERAL.....	7
VII.	ENTRIES	9
1.	ENTRY DATES AND ENTRY FEES.....	9
2.	OTHER FEES	10
3.	NO-SHOWS/LATE WITHDRAWALS.....	11
VIII.	TIMETABLE.....	12
IX.	COMPETITION DETAIL.....	13
X.	FACILITIES OFFERED.....	23
1.	ATHLETES.....	23
2.	GROOMS.....	23
XI.	LOGISTICAL/ADMINISTRATIVE/TECHNICAL INFORMATION	24
1.	DRAW	24
2.	COMPETITION ARENA(S)	24
3.	PRACTICE ARENA(S)	24
4.	STABLES	24
5.	SAFETY CUPS.....	24
6.	TIMING DEVICE	24
7.	SCORING/TIMING PROVIDER.....	24
8.	OTHER TECHNOLOGY/SERVICE PROVIDER(S)	24
9.	PRIZE GIVING CEREMONY	25
10.	ADVERTISING ON ATHLETES AND HORSES.....	25
11.	TICKETING.....	25
12.	BETTING.....	25
13.	TRANSPORT REIMBURSEMENT HORSES / PONIES	25
14.	WELCOME.....	25
15.	LOCAL TRANSPORTATION - ARRANGEMENTS FROM HOTEL TO SHOWGROUNDS	25
16.	ENTRY RIGHT TO SHOWGROUNDS/ACCREDITED PERSONS.....	25
17.	SUSTAINABILITY.....	26
XII.	VETERINARY MATTERS.....	27
1.	CUSTOMS FORMALITIES	27
2.	HEALTH REQUIREMENTS	27
3.	NATIONAL REQUIREMENTS	27
4.	PONIES.....	27
5.	INJURY SURVEILLANCE.....	27
6.	TRANSPORT OF HORSES.....	28
7.	VENUE ARRIVAL INFORMATION & FITNESS TO COMPETE	28
8.	EQUINE ANTI-DOPING AND CONTROLLED MEDICATION PROGRAMME (EADCMP). FEI VETERINARY REGULATIONS,	

CHAPTER VII	29
XIII. HUMAN ANTI-DOPING	30
XIV. ADDITIONAL INFORMATION	30
1. INSURANCES AND NATIONAL REQUIREMENTS.....	30
2. PROTESTS/APPEALS.....	31
3. SCHOOLING DURING COMPETITIONS.....	31
4. STEWARDING.....	31
5. DISPUTES	32
6. MODIFICATION TO SCHEDULE	32
7. ADDITIONAL INFORMATION FROM THE OC.....	32
8. PRIZE MONEY DISTRIBUTION.....	34
9. MAXIMUM NUMBER OF STARTERS PER COMPETITION	35
10. GLOSSARY	36
XV. ANNEXES.....	38

III. THE FEI CODE OF CONDUCT FOR THE WELFARE OF THE HORSE

The Fédération Equestre Internationale (FEI) expects all those involved in international equestrian sport to adhere to the FEI's Code of Conduct and to acknowledge and accept that at all times the welfare of the horse must be paramount and must never be subordinated to competitive or commercial influences.

1. At all stages during the preparation and training of competition horses, welfare must take precedence over all other demands. This includes good horse management, training methods, farriery and tack, and transportation.
2. Horses and Athletes must be fit, competent and in good health before they are allowed to compete. This encompasses medication use, surgical procedures that threaten welfare or safety, pregnancy in mares and the misuse of aids.
3. Events must not prejudice horse welfare. This involves paying careful attention to the competition areas, ground surfaces, weather conditions, stabling, site safety and fitness of the horse for onward travel after the event.
4. Every effort must be made to ensure that horses receive proper attention after they have competed and that they are treated humanely when their competition careers are over. This covers proper veterinary care, competition injuries, euthanasia and retirement.
5. The FEI urges all involved with the sport to attain the highest levels of education in their areas of expertise.

The Long version of this Code can be obtained from the Fédération Equestre Internationale, HM King Hussein I Building, Chemin de la Joliette 8, 1006 Lausanne, Switzerland. Telephone: +41 21 310 47 47. The Code is available in English. The Code is also available on the FEI's website: <http://inside.fei.org/>.

IV. GENERAL INFORMATION

1. ORGANISER

Name: CIRCUITO HÍPICO DEL SOL, S.L.
Address: Dehesa Montenmedio. Carretera Nacional 340, Km.41.3 11150 Vejer de la Frontera (Cádiz-Spain)
Telephone: +34 956 447 125 / +34 649 293 273
Fax:
Email: sunshinetour@sunshinetour.net
Website: www.sunshinetour.net

Contact Details Show Ground:

Address: Dehesa Montenmedio. Carretera Nacional 340, Km.41.3 11150 Vejer de la Frontera (Cádiz-Spain)

CODIGO DE EXPLOTACION O REGA: ES 110390000780

Telephone: +34 956 447 125 / +34 649 293 273

GPS Coordinates: Long 36.15 Lat -5.54 (Sunshine Tour)

Accessibility details (directions by road, nearest airport / train station):

The venue is situated between Km. 41 to 42.5 of National Road 340 (E-5):

- Main entrance for trucks and participants for stable Area A & B is at Km 41.4.

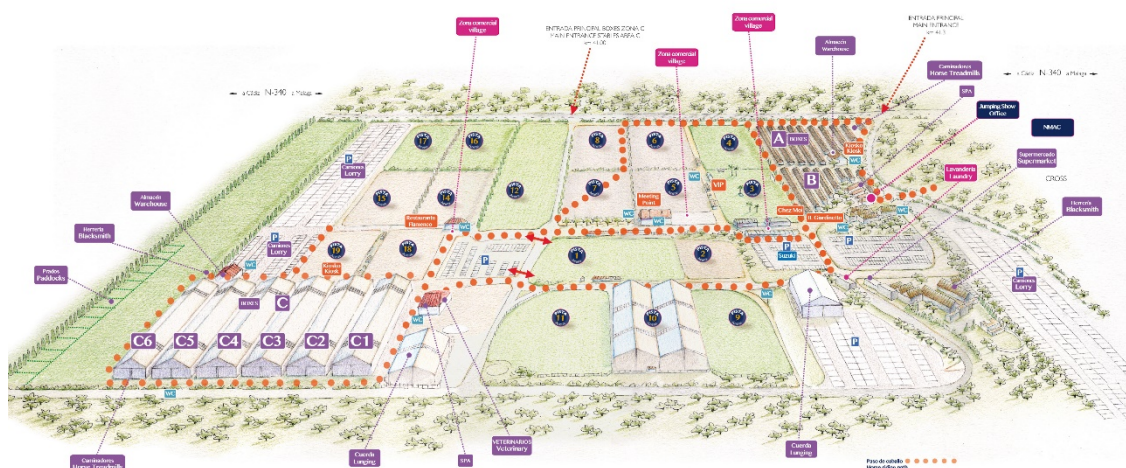

Nearest International Airports: Jerez de la Frontera (85 Km); Gibraltar (84 Km); Sevilla (160Km) & Málaga (195Km).

Nearest Train Station: San Fernando-Bahía Sur (49 Km).

2. ORGANISING COMMITTEE

Honorary President:
President of the Event: Mr. Antonio Blázquez Marín
Show Secretary: Mrs. Begoña Quirós
Press Officer: Mrs. Begoña Quirós

3. EVENT DIRECTOR

Name: Mrs. Teresa Blázquez Abascal
Address: Carretera Nacional 340, Km.41.3 11150 Vejer de la Frontera

(Cádiz-Spain)

Telephone: +34 956 447 125

Mobile: +34 649 293 273

Fax:

Email: tblazquez@sunshinetour.net

4. STABLE MANAGER

Name: Mr. Juan Antonio Naveda Braza

Telephone: +34 956 447 125

Email: sunshinetour@sunshinetour.net

5. ANNOUNCER

Name: Sunshine Tour - Circuito Hípico del Sol

Email: sunshinetour@sunshinetour.net

V. OFFICIALS

Ref.	Panel	Function	FEI ID	Name	NF	Level	E-mail & Mobile
1	Ground Jury	Ground Jury President	10011044	Mrs. Teresa Martins	POR	3*	teresabmartins@gmail.com +351 911 008 364
		Ground Jury Member	10077746	Mr. Manuel Carvalho Martins	POR	3*	manuelcmartins13@gmail.com +351 934 823 050
		Ground Jury Member	10052326	Mr. Joaquin Medina García	ESP	2*	joaquinmedinahipica@gmail.com
2	Foreign Judge	Foreign Judge	10059041	Mrs. Maria Teresa Pires Miranda	POR	3*	teresamiranda@netcabo.pt +351 917 577 468
3	Foreign Technical Delegate	Foreign Technical Delegate					
4	Course Designer	Course Designer	10052875	Mrs. Elena Boix Gracia	ESP	3*	eboixg@hotmail.com +34 625 40 55 35
		Assistant Course Designer	10174763	Mr. Marcos Núñez García-Delgado	ESP	2*	marcosngd@hotmail.com
		Assistant Course Designer	10049471	Mr. Javier Trenor	ESP	4*	chatrenor@hotmail.com
5	Chief Steward	Chief Steward	10094814	Mrs. Auxiliadora Carrión Lojo	ESP	2*	carrionauxi@gmail.com +34 607 920 322
6	Foreign Steward	Foreign Steward					*
7	Assistants Stewards	Assistant Steward	10108054	Mrs. Sara López Carrión	ESP	1*	saritadecai@hotmail.com
		Assistant Steward	10108049	Mr. Javier Freire Lacave	ESP	1*	javi_cbc@hotmail.com
		Assistant Steward	10108048	Mrs. Sara de la Torre	ESP	1*	storredel1@gmail.com
		Assistant Steward	10106838	Mr. François Pfyffer	SUI	1*	slidingmotion@gmail.com
8	FEI Veterinary Delegate	FEI Veterinary Delegate	10095054	Mrs. Isabel Cienfuegos Marco	ESP		isabelcienfuegosm@hotmail.com +34 626 900 068
9	Veterinary Service Manager / Treating Veterinarian	Veterinary Service Manager	10177258	Mrs. María Aguirre Calderón	ESP		aguirrevet@hotmail.com +34 662 18 66 85
		FEI Permitted Treating Veterinarian	10177258	Mrs. María Aguirre Calderón	ESP		aguirrevet@hotmail.com +34 662 18 66 85
10	Medical Doctor	Medical Doctor		Ambulancias Barbate	ESP		+34 956 447 125
11	Farrier	Farrier		Mr. Julio Guisado Rawas	ESP		+34 666 430 800

Please note that the schedule has been approved under the provision that all appointed Officials have successfully passed the on-line FEI Competency Evaluation Test.

VI. INVITATIONS

1. GENERAL

Horses entered in one CSI star level may not enter another CSI star level at the same Event.

Horses may take part in national Competitions and international Competitions at the same Event only under the following conditions:

- Horses may take part in national Events up to two hours prior to the start of the international Event's Horse Inspection;
- If the national Event includes Competitions after the international Event ends, either on the same day or on the following day(s). Horses having taken part in the international Event may take part in national Competitions only, following the conclusion of the international Event.

CSI Invitation Rules as per 2020 JRs Annex V apply to ~~CSI2*/CSI3*/CSI4*/CSI5*~~

NB: Pursuant to FEI Board resolution of 08/04/2020, the CSI Invitation Rules do not apply to 2020 CSI2* events taking place as of week 24 (08.06.2020 – 14.06.2020).

Invitations

For all Events at which the CSI Invitation Rules apply, a certain percentage of Athletes must be invited in descending order of the Longines Ranking, a certain percentage of Athletes will be home Athletes selected by the host NF and a certain percentage will be Athletes invited by the Organising Committee (OC); the percentages for each invitation group are established for each star level as follows:

Event Level	Athletes from the Longines Ranking	Athletes selected by the host NF	OC Invitations
CSI5*	60%	20%	20%
CSI4*	50%	25%	25%
CSI3*	40%	30%	30%
CSI2* N/A as of week 24	30%	30%	40%
CSI2* option with no Longines Ranking Competitions N/A as of week 24 (option available only for CSI2* that are combined with CSI3*, 4* or 5*, upon specific request of the OC)	0%	20%	80%

If an OC decides not to limit the number of Athletes, no limit can be set on the maximum number of horses and all entries will therefore automatically be accepted.

CSI3*/CSIYH:

Maximum number of Athletes to be invited: UNLIMITED

Maximum number of Horses that may be entered: UNLIMITED

CSIYH* (5,6 & 7 y/o):

Number of horses per athlete: **9 horses/rider (max.3 per age)**

CSI3*:

Number of horses per athlete: **12 Horses max/rider (4 Max. Small/Medium/Big)** as follows:

Small Class A (1.10m): 2 per rider

Small Class B (1.20-1.25m): 2 per rider

Medium Class A (1.30m): 2 per rider

Medium Class B (1.35m): 2 per rider

Big Class A (1.40m): 2 per rider

Big Class B (1.45-1.50m): 1 per rider

Classes with heights max.1.30m are open for children 12-13 years old with the express permission of their NF (Art. 255 JRs).

Classes with heights max.1.40m are open for children 14-15 years old with the express permission of their NF (Art. 255 JRs).

Each horse can jump one class per day, but max. 3 classes per week!

Athletes are invited by the Organiser through their National Federation.

One (1) groom per athlete.

All riders should get in contact with the show office before the date of the definite entries.

Definite Entries: 09/11/2020

**The number of stables is binding with the deposit payment.
A prepayment of 100€/horse/week must be done to the following account:**

Holder: CIRCUITO HÍPICO DEL SOL, S.L.

Bank : UNICAJA BANK

IBAN : ES27 2103 4020 0100 3000 7954

SWIFT Nº : UCJAES2MXXX

Bank address: Avenida de Andalucía, Nº 17

11150 Vejer de la Frontera

Cádiz – Spain

The deposit is not refundable for cancellation after 20.10.2020.

VII. ENTRIES

IMPORTANT

- Entries must be made by NFs through the FEI Entry System for all categories of this Event (<https://invitation.fei.org/login>);
- Additional documentation can be found at: <https://inside.fei.org/fei/your-role/it-services/fei-entry-system/fei-entry-system-jumping>;
- All Athletes and Horses participating in any International Competition must be registered with the FEI;
- Athletes and/or Horses present at the Event without having been entered through the FEI's Online Entry System will be automatically disqualified unless compelling circumstances warrant otherwise.

1. ENTRY DATES AND ENTRY FEES

Entries have to be in accordance with Art.251 of the FEI Jumping Rules, 26th edition, updates effective 1 January 2020

Deadlines for Entries:

Definite Entries: **09/11/2020**

Last date for substitutions: **18/11/2020**

Entry fee per horse (per category):

VAT excluded

Stabling included

CSI3*: 450€/event

CSIYH*: 300€/event

Non-competing: 300€/event

VAT (in %) : **21%**

Please refer to definition of Entry fees and Compulsory fees in the Glossary of the FEI Jumping Rules 26th edition, updates effective 1 January 2020, that is copied in Section XIV point 10.

Compulsory fees per horse:

- EADCMP Fee: Included in entry fee
Not included in entry fee
Lower Level Events (CIMs) CHF 18 per horse per event
Higher Level Events CHF 25 per horse per event
(For definition of CIMs see Appendix E of the FEI General Regulations, all other events not defined as CIMs)
- Fee for manure disposal (at OC discretion; maximum € 40 per horse per Event).
40€ Per horse
- Fee for health/customs-related documents for Horses, if applicable (only if requested) 35€ Per horse

All aforementioned amounts are including VAT

Total maximum fee per horse: 75€ + 18 CHF (Lower

Events) or 25 CHF
(Higher Events)

Compulsory fees per athlete:

- NF fee if applicable Per athlete
- NF medication control programme fee if applicable Per athlete
- Fee for lorry parking if applicable 80€/week Per
lorry/caravan
- Fee for electric hook-up for lorry 60€/week since arrival
Per lorry/caravan

All aforementioned amounts are including VAT

Total maximum fee per Athlete:
of lorries

Depending on number

2. OTHER FEES

All other fees must optional fees and be listed hereunder with the details of the amounts to be charged and approved by the FEI. Only fees approved by the FEI and listed in the approved Schedule can be charged by the OC. Please specify if price per bale or other quantity.

- Hay: 9.90€ per bale
- Straw: 6.60€ per bale
- Shavings: 11.07 per bale / National - 12.34€ per bale / Imported
- Other (please specify):
- Tack room (permanent stables): 80€/week
Only limited number available in permanent stables
 - Fee for parking Trailer, if requested 40 €/ week
 - Fee for electric hook-up for Trailer, if requested 20 €/ week
 - Large stable (only with certificate) 60.50 € per stable
 - Unloading feed: 60.50€/pallet (max.242€)

THE OC WILL NOT ACCEPT THE DELIVERY OF HAY, SHAVINGS AND STRAW BY OTHERS SUPPLIERS ON THE SHOW GROUND! FOR ANY ILLEGAL DELIVERY WE WILL CHARGE THE ATHLETE 1.000€.

All aforementioned amounts are including VAT

VAT number of the organiser: ES B41819673
The payments done by credit card American Express will have an additional surcharge of 3.00%.
All riders accounts must be closed before departure.
Payments must be done by credit card or bank transfer one week before leaving the facilities.

3. NO-SHOWS/LATE WITHDRAWALS

NB: In the case of withdrawals after the date of definite entries or no-shows the athlete or the respective NF will be held liable to reimburse the OC for the actual financial loss incurred by the OC (i.e. stabling and hotel expenses) as a result of the late withdrawal or no-show.

Amount charged: 100% of the total entry fee per horse.

IMPORTANT:

- All horses not staying for Competition VI: CSIO3* - CS12* - CS1YH* 6th week: 26th - 29th November have to leave the facilities on Tuesday 24.11.2020 before 9.00 a.m.

VIII. TIMETABLE

Competitions must not start before 08:00 and must not finish after 23:00, unless prior approval is granted by the FEI.

As per Jumping Rules Annex VI: combined competitions are not permitted.

The scheduling of competitions must take into account mandatory maintenance breaks as follows. In principle, there should be one maintenance break for every 40 starters; at a minimum, it is compulsory to include one maintenance break in competitions with 50-99 starters after half of the starters have competed. Competitions with 100 starters or more must have three maintenance breaks. The start list must indicate when the maintenance break will take place (e.g. after N° 25).

(to be provided per category/level if multiple events)

	Day	Date	Time
• Opening of stables	Wednesday	18/11/2020	10:00
• Horse Inspection <i>All horses taking part at this Event must be present during the first horse inspection, unless unable to do so due to "force majeure"</i>	Friday	20/11/2020	16:00
• Horse Re-Inspection	Saturday	21/11/2020	08:30
• Opening times of exercise areas	Daily		09:00-17:00

CSI3*/CSIYH* 21st – 23rd November

No.	CLASSES	DATE		ART	Type	HEIGHT	PRIZE MONEY CSIYH*	PRIZE MONEY CSI3*
1	5 Y/O	Saturday	21/11/2020	238.1.1	FnoT	1,15	500,00 €	
2	6-7 Y/O	Saturday	21/11/2020	274.2.5	2Ph sp	1,25/1,35	1.100,00 €	
3	1,10	Saturday	21/11/2020	238.2.1	FT	1,10		400,00 €
4	1,20	Saturday	21/11/2020	238.2.1	FT	1,20		500,00 €
5	1,30	Saturday	21/11/2020	274.2.5	2Ph sp	1,30		1.000,00 €
6	1,35	Saturday	21/11/2020	238.2.1	FT	1,35		2.000,00 €
7	1,40	Saturday	21/11/2020	238.2.1	FT	1,40		3.000,00 €
8	1,45	Saturday	21/11/2020	238.2.1	FT	1,45		25.400,00 €
9	5 Y/O	Sunday	22/11/2020	274.2.5	2Ph sp	1,15	500,00 €	
10	6-7 Y/O	Sunday	22/11/2020	238.2.1	FT	1,25/1,35	1.100,00 €	
11	1,10	Sunday	22/11/2020	238.2.1	FT	1,10		400,00 €
12	1,20	Sunday	22/11/2020	269	ACC	1,20		500,00 €
13	1,30	Sunday	22/11/2020	238.2.1	FT	1,30		1.000,00 €
14	1,35	Sunday	22/11/2020	274.2.5	2Ph sp	1,35		2.000,00 €
15	1,40	Sunday	22/11/2020	238.2.2	JO	1,40		4.000,00 €
16	1,45	Sunday	22/11/2020	238.2.1	FT	1,45		25.400,00 €
17	5 Y/O	Monday	23/11/2020	238.2.2	JO	1,15	700,00 €	
18	6-7 Y/O	Monday	23/11/2020	238.2.2	JO	1,25/1,35	1.500,00 €	

FEI APPROVED SCHEDULE
Vejer de la Frontera 21-23 November 2020



19	1,10	Monday	23/11/2020	238.2.1	FT	1,10		400,00 €
20	1,25	Monday	23/11/2020	238.2.1	FT	1,25		500,00 €
21	1,30	Monday	23/11/2020	238.2.1	FT	1,30		1.000,00 €
22	1,35	Monday	23/11/2020	274.2.5	2Ph sp	1,35		2.000,00 €
23	1,40	Monday	23/11/2020	238.2.1	FT	1,40		3.000,00 €
25	1,45	Monday	23/11/2020	274.2.5	2 Ph sp	1,45		4.000,00 €
24	1,50	Monday	23/11/2020	238.2.2	JO	1,50		54.200,00 €

Total CSI 3*: **130.700€**

Total CSI YH*: 5.400€

Overall Prize Money: **136.100€**

Applicable government tax to be deducted from Prize Money (see also XIV.8): _____%

GENERAL CLASSIFICATION AT THE END OF THE COMPETITIONS:

Leading athlete award –	(Prize description and value)
Best foreign athlete -	(Prize description and value)
Best home athlete –	(Prize description and value)
Team awards –	(Prize description and value)

IX. COMPETITION DETAIL

CSI 3*/CSI YH*
21st – 23rd November

The timetable will be announced the day before each competition.

FIRST DAY: SATURDAY DATE (dd/mm/yy): 21/11/2020

COMPETITION No: 1

Type of Competition: Table A not against the clock

Acc. to Article: 238.1.1

Competition description: **CSI YH* FIVE YEARS OLD HORSES**

Jump-off (if any)	None
Speed/Fixed time	350m/min
Height of obstacles:	1.15m
Number of horses per athlete	3
Number of Starters:	100* (if more than 100 take part then please refer to
Section XIV point 9)	
Total prize money:	500€
Chart to be used:	1 (25% to winner) <input checked="" type="checkbox"/>
	2 (33% to winner) <input type="checkbox"/>

Please specify prize money amount for each athlete placed 13th and beyond: 5€

* * * * *

COMPETITION No: 2

Type of Competition: 2 Phases Special

Acc. to Article: 274.2.5

Competition description: **CSIYH* SIX & SEVEN YEARS OLD HORSES**

Open to 6 and 7 years old horses

Jump-off (if any)	None
Speed/Fixed time	350m/min
Height of obstacles:	
For 6 years old horses:	1.25m
For 7 years old horses:	1.35m
Number of horses per athlete	3 per age
Number of Starters:	100* (if more than 100 take part then please refer to Section XIV point 9)
Total prize money:	1.100€
Chart to be used:	1 (25% to winner) <input checked="" type="checkbox"/>
	2 (33% to winner) <input type="checkbox"/>

Please specify prize money amount for each athlete placed 13th and beyond: 10€

* * * * *

COMPETITION No: 3

Type of Competition: Table A against the clock

Acc. to Article: 238.2.1

Competition description: **CSI3* SMALL CLASS A**

Jump-off (if any)	None
Speed/Fixed time	350m/min
Height of obstacles:	1.10m
Number of horses per athlete	2
Number of Starters:	100* (if more than 100 take part then please refer to Section XIV point 9)
Total prize money:	400€
Chart to be used:	1 (25% to winner) <input checked="" type="checkbox"/>
	2 (33% to winner) <input type="checkbox"/>

Please specify prize money amount for each athlete placed 13th and beyond: 4€

* * * * *

COMPETITION No: 4

Type of Competition: Table A against the clock

Acc. to Article: 238.2.1

Competition description: **CSI3* SMALL CLASS B**

Jump-off (if any)	None
Speed/Fixed time	350m/min
Height of obstacles:	1.20m
Number of horses per athlete	2
Number of Starters:	100* (if more than 100 take part then please refer to Section XIV point 9)
Total prize money:	500€
Chart to be used:	1 (25% to winner) <input checked="" type="checkbox"/>
	2 (33% to winner) <input type="checkbox"/>

Please specify prize money amount for each athlete placed 13th and beyond: 5€

* * * * *

COMPETITION No: 5

Type of Competition: 2 Phases Special

Acc. to Article: 274.2.5

Competition description: **CSI3* MEDIUM CLASS A**

Jump-off (if any) None
Speed/Fixed time 350m/min
Height of obstacles: 1.30 m
Number of horses per athlete 2
Number of Starters: 100* (if more than 100 take part then please refer to
Section XIV point 9)
Total prize money: 1.000€
Chart to be used: 1 (25% to winner)
2 (33% to winner)

Please specify prize money amount for each athlete placed 13th and beyond: 10€

* * * * *

COMPETITION No: 6

Type of Competition: Table A against the clock

Acc. to Article: 238.2.1

Competition description: **CSI3* MEDIUM CLASS B**

Jump-off (if any) None
Speed/Fixed time 350m/min
Height of obstacles: 1.35 m
Number of horses per athlete 2
Number of Starters: 100* (if more than 100 take part then please refer to
Section XIV point 9)
Total prize money: 2.000€
Chart to be used: 1 (25% to winner)
2 (33% to winner)

Please specify prize money amount for each athlete placed 13th and beyond: 20€

* * * * *

COMPETITION No: 7

Type of Competition: Table A against the clock

Acc. to Article: 238.2.1

Competition description: **CSI3* BIG CLASS A**

Jump-off (if any) None
Speed/Fixed time 375m/min
Height of obstacles: 1.40m
Number of horses per athlete 2
Number of Starters: 100* (if more than 100 take part then please refer to
Section XIV point 9)
Total prize money: 3.000€
Chart to be used: 1 (25% to winner)
2 (33% to winner)

Please specify prize money amount for each athlete placed 13th and beyond: 30€

* * * * *

COMPETITION No: 8 (QUALIFIER FOR CLASS 16 & 24)

FEI APPROVED SCHEDULE
Vejer de la Frontera 21-23 November 2020



Type of Competition: Table A against the clock
Acc. to Article: 238.2.1
Competition description: **CSI3* BIG CLASS B**

This class counts for the Longines Ranking Group D (LR 1)

The best 100 riders will qualify for the Big Class B Class 16 (1.45m-Sunday)
The best 30 placed riders qualify for the Big Class GP Class 24 (1.50m-Monday)

Should the overall number of riders be equal to/less than 100 no qualification system will be applied.

Jump-off (if any)	None
Speed/Fixed time	375m/min
Height of obstacles:	1.45m
Number of horses per athlete	1
Number of Starters:	100* (if more than 100 take part then please refer to Section XIV point 9)
Total prize money:	25.400€
Chart to be used:	1 (25% to winner) <input checked="" type="checkbox"/>
	2 (33% to winner) <input type="checkbox"/>

Please specify prize money amount for each athlete placed 13th and beyond: 125€

* * * * *

SECOND DAY: SUNDAY

DATE (dd/mm/yy): 22/11/2020

COMPETITION No: 9

Type of Competition: 2 Phases Special
Acc. to Article: 274.2.5
Competition description: **CSIYH* FIVE YEARS OLD HORSES**

Jump-off (if any)	None
Speed/Fixed time	350m/min
Height of obstacles:	1.15m
Number of horses per athlete	3
Number of Starters:	100* (if more than 100 take part then please refer to Section XIV point 9)
Total prize money:	500€
Chart to be used:	1 (25% to winner) <input checked="" type="checkbox"/>
	2 (33% to winner) <input type="checkbox"/>

Please specify prize money amount for each athlete placed 13th and beyond: 5€

* * * * *

COMPETITION No: 10

Type of Competition: Table A against the clock
Acc. to Article: 238.2.1
Competition description: **CSIYH* SIX & SEVEN YEARS OLD HORSES**
Open to 6 and 7 years old horses

Jump-off (if any)	None
Speed/Fixed time	350m/min
Height of obstacles:	
For 6 years old horses:	1.25m
For 7 years old horses:	1.35m

FEI APPROVED SCHEDULE
Vejer de la Frontera 21-23 November 2020



Number of horses per athlete 3 per age
Number of Starters: 100* (if more than 100 take part then please refer to
Section XIV point 9)
Total prize money: 1.100€
Chart to be used: 1 (25% to winner)
2 (33% to winner)
Please specify prize money amount for each athlete placed 13th and beyond: 10€

* * * * *

COMPETITION No: 11

Type of Competition: Table A against the clock
Acc. to Article: 238.2.1
Competition description: **CSI3* SMALL CLASS A**

Jump-off (if any) None
Speed/Fixed time 350m/min
Height of obstacles: 1.10m
Number of horses per athlete 2
Number of Starters: 100* (if more than 100 take part then please refer to
Section XIV point 9)
Total prize money: 400€
Chart to be used: 1 (25% to winner)
2 (33% to winner)
Please specify prize money amount for each athlete placed 13th and beyond: 4€

* * * * *

COMPETITION No: 12

Type of Competition: Accumulator
Acc. to Article: 269.1,2.3.5
Competition description: **CSI3* SMALL CLASS B**

Jump-off (if any) None
Speed/Fixed time 350m/min
Height of obstacles: 1.20m
Number of horses per athlete 2
Number of Starters: 100* (if more than 100 take part then please refer to
Section XIV point 9)
Total prize money: 500€
Chart to be used: 1 (25% to winner)
2 (33% to winner)
Please specify prize money amount for each athlete placed 13th and beyond: 5€

* * * * *

COMPETITION No: 13

Type of Competition: Table A against the clock
Acc. to Article: 238.2.1
Competition description: **CSI3* MEDIUM CLASS A**

Jump-off (if any) None
Speed/Fixed time 350m/min
Height of obstacles: 1.30m
Number of horses per athlete 2
Number of Starters: 100* (if more than 100 take part then please refer to
Section XIV point 9)

Total prize money: 1.000€
Chart to be used: 1 (25% to winner)
2 (33% to winner)
Please specify prize money amount for each athlete placed 13th and beyond: 10€

* * * * *

COMPETITION No: 14

Type of Competition: 2 Phases Special
Acc. to Article: 274.2.5
Competition description: **CSI3* MEDIUM CLASS B**

Jump-off (if any) None
Speed/Fixed time 350m/min
Height of obstacles: 1.35m
Number of horses per athlete 2
Number of Starters: 100* (if more than 100 take part then please refer to
Section XIV point 9)
Total prize money: 2.000€
Chart to be used: 1 (25% to winner)
2 (33% to winner)
Please specify prize money amount for each athlete placed 13th and beyond: 20€

* * * * *

COMPETITION No: 15

Type of Competition: Table A against the clock with Jump Off
Acc. to Article: 238.2.2
Competition description: **CSI3* BIG CLASS A**

Jump-off (if any) One
Speed/Fixed time 375m/min
Height of obstacles: 1.40m
Number of horses per athlete 2
Number of Starters: 100* (if more than 100 take part then please refer to
Section XIV point 9)
Total prize money: 4.000€
Chart to be used: 1 (25% to winner)
2 (33% to winner)
Please specify prize money amount for each athlete placed 13th and beyond: 40€

* * * * *

COMPETITION No: 16 (QUALIFIER FOR CLASS 24)

Type of Competition: Table A against the clock
Acc. to Article: 238.2.1
Competition description: **CSI3* BIG CLASS B**

This class counts for the Longines Ranking Group D (LR 2)

Open to the best 100 placed riders of class 8 Big Class B (1.45m-Saturday)
The best 30 placed riders qualify for the Big Class GP Class 24 (1.50m-Monday)

If a qualified rider does not start or is already qualified, he will be replaced by the next rider up until 4 hours prior to the competition.

Art. 254.6. If there are 50 starters or less, each Athlete may ride two Horses.

Jump-off (if any) None
Speed/Fixed time 375m/min
Height of obstacles: 1.45m
Number of horses per athlete 1
Number of Starters: 100
Total prize money: 25.400€
Chart to be used: 1 (25% to winner)
2 (33% to winner)
Please specify prize money amount for each athlete placed 13th and beyond: 125€

* * * * *

THIRD DAY: MONDAY **DATE (dd/mm/yy): 23/11/2020**

COMPETITION No: 17

Type of Competition: Table A against the clock with Jump Off
Acc. to Article: 238.2.2
Competition description: **CSIYH* FIVE YEARS OLD HORSES**

Jump-off (if any) None
Speed/Fixed time 350m/min
Height of obstacles: 1.15m
Number of horses per athlete 3
Number of Starters: 100* (if more than 100 take part then please refer to
Section XIV point 9)
Total prize money: 700€
Chart to be used: 1 (25% to winner)
2 (33% to winner)
Please specify prize money amount for each athlete placed 13th and beyond: 7€

* * * * *

COMPETITION No: 18

Type of Competition: Table A against the clock with Jump Off
Acc. to Article: 238.2.2
Competition description: **CSIYH* SIX & SEVEN YEARS OLD HORSES**
Open to 6 and 7 years old horses

Jump-off (if any) None
Speed/Fixed time 350m/min
Height of obstacles:
For 6 years old horses: 1.25m
For 7 years old horses: 1.35m
Number of horses per athlete 3 per age
Number of Starters: 100* (if more than 100 take part then please refer to
Section XIV point 9)
Total prize money: 1.500€
Chart to be used: 1 (25% to winner)
2 (33% to winner)
Please specify prize money amount for each athlete placed 13th and beyond: 10€

* * * * *

COMPETITION No: 19

Type of Competition: Table A against the clock

Acc. to Article: 238.2.1

Competition description: **CSI3* SMALL CLASS A**

Jump-off (if any)	None
Speed/Fixed time	350m/min
Height of obstacles:	1.10m
Number of horses per athlete	2
Number of Starters: Section XIV point 9)	100* (if more than 100 take part then please refer to
Total prize money:	400€
Chart to be used:	1 (25% to winner) <input checked="" type="checkbox"/>
	2 (33% to winner) <input type="checkbox"/>

Please specify prize money amount for each athlete placed 13th and beyond: 4€

* * * * *

COMPETITION No: 20

Type of Competition: Table A against the clock

Acc. to Article: 238.2.1

Competition description: **CSI3* SMALL CLASS B**

Jump-off (if any)	None
Speed/Fixed time	350m/min
Height of obstacles:	1.25m
Number of horses per athlete	2
Number of Starters: Section XIV point 9)	100* (if more than 100 take part then please refer to
Total prize money:	500€
Chart to be used:	1 (25% to winner) <input checked="" type="checkbox"/>
	2 (33% to winner) <input type="checkbox"/>

Please specify prize money amount for each athlete placed 13th and beyond: 5€

* * * * *

COMPETITION No: 21

Type of Competition: Table A against the clock

Acc. to Article: 238.2.1

Competition description: **CSI3* MEDIUM CLASS A**

Jump-off (if any)	None
Speed/Fixed time	350m/min
Height of obstacles:	1.30m
Number of horses per athlete	2
Number of Starters: Section XIV point 9)	100* (if more than 100 take part then please refer to
Total prize money:	1.000€
Chart to be used:	1 (25% to winner) <input checked="" type="checkbox"/>
	2 (33% to winner) <input type="checkbox"/>

Please specify prize money amount for each athlete placed 13th and beyond: 10€

* * * * *

COMPETITION No: 22

Type of Competition: 2 Phases Special

Acc. to Article: 274.2.5

Competition description: **CSI3* MEDIUM CLASS B**

FEI APPROVED SCHEDULE
Vejer de la Frontera 21-23 November 2020



Jump-off (if any) None
Speed/Fixed time 350m/min
Height of obstacles: 1.35m
Number of horses per athlete 2
Number of Starters: 100* (if more than 100 take part then please refer to
Section XIV point 9)
Total prize money: 2.000€
Chart to be used: 1 (25% to winner)
2 (33% to winner)
Please specify prize money amount for each athlete placed 13th and beyond: 20€

* * * * *

COMPETITION No: 23

Type of Competition: Table A against the clock
Acc. to Article: 238.2.1
Competition description: **CSI3* BIG CLASS A**

Jump-off (if any) None
Speed/Fixed time 375m/min
Height of obstacles: 1.40m
Number of horses per athlete 2
Number of Starters: 100* (if more than 100 take part then please refer to
Section XIV point 9)
Total prize money: 3.000€
Chart to be used: 1 (25% to winner)
2 (33% to winner)
Please specify prize money amount for each athlete placed 13th and beyond: 30€

* * * * *

COMPETITION No: 25

Type of Competition: 2 Phases Special
Acc. to Article: 274.2.5
Competition description: **CSI3* BIG CLASS B**

Jump-off (if any) None
Speed/Fixed time 375m/min
Height of obstacles: 1.45m
Number of horses per athlete 2
Number of Starters: 100* (if more than 100 take part then please refer to
Section XIV point 9)
Total prize money: 4.000€
Chart to be used: 1 (25% to winner)
2 (33% to winner)
Please specify prize money amount for each athlete placed 13th and beyond: 30€

* * * * *

COMPETITION No: 24

Type of Competition: Table A against the clock with Jump Off
Acc. to Article: 238.2.1 + FEI Olympic Regulations Art. 632.6.1
Competition description: **CSI3* BIG CLASS GP**

This competition will count as a competition where athletes and horses, as a combination, can achieve the Minimum Eligibility Requirements (MER) or the Confirmation Result for the Tokyo Olympic Games in 2021 providing the course meets the following specifications: consist of at least

12 obstacles which may vary in height between 1.40m and 1.60m. The spread obstacles must have spreads of between 1.50m to 2.00m (2.20m for the triple bar). At least two straight obstacles must be provided with a minimum height of 1.60m.

The Foreign Judge is responsible for ensuring that the course is built to the required dimensions and must confirm to the FEI through the Foreign Judge Report whether or not the course requirements have been met and must upload/sent the course plan including all heights and dimensions.

This class counts for the Longines Ranking Group C (LR 3)

Open to the best 30 placed riders of class 8 Big Class B (1.45m-Saturday) and the best placed riders of class 16 Big Class B (1.45m-Sunday) until the number of 60 starters is reached.

If a qualified rider does not start or is already qualified, he will be replaced by the next rider up until 4 hours prior to the competition.

Should the overall number of riders be equal to/less than 60 no qualification system will be applied.

Art. 254.6. If there are 30 starters or less, each Athlete may ride two Horses.

Jump-off (if any)	One
Speed/Fixed time	375m/min
Height of obstacles:	1.50m (2 verticals of 1m60 compulsory)
Number of horses per athlete	1
Number of Starters:	60
Total prize money:	54.200€
Chart to be used:	1 (25% to winner) <input checked="" type="checkbox"/>
	2 (33% to winner) <input type="checkbox"/>

Please specify prize money amount for each athlete placed 13th and beyond: 250€

Art.261.4.2

The following Athletes (not Athlete/Horse combinations) are automatically qualified for the Grand Prix at CSI Events, if present:

261.4.2.1 The winner of that Event's Grand Prix the previous year; according to the following conditions:

- For the Grand Prix at a CSI3*/CSI4*/CSI5* Event, the winner of that Event's Grand Prix the previous year is eligible to participate, providing the previous year's Event was the same star level or a higher star level;

- For the Grand Prix at a CSI1*/CSI2*, the winner of that Event's Grand Prix the previous year is eligible to participate, regardless of the star level of the previous year's Event;

261.4.2.2 The current National Jumping Champion of the host country;

261.4.2.3 The individual medal winners of the last Olympic and Pan-American Games, the last World and Continental Championships and the winner of the last FEI World Cup™ Final.

All Athletes qualified for the Grand Prix, including those automatically qualified must complete, with their Grand Prix horse, the initial round of at least one competition prior to the Grand Prix.

* * * * *

X. FACILITIES OFFERED

1. ATHLETES

Accommodation

Hotel:
Address:
Telephone:

At the expense of: The Organiser or Athletes
Accommodated (bed and breakfast) from _____ to _____

Requests for accomodation: sunshinetour@sunshinetour.net

Meals

At the expense of: The Organiser or Athletes
Meals provided from _____ to _____ .

2. GROOMS

Accommodation.

Requests for accommodation must be sent with entries.

At the expense of: The Organiser or Athletes
Accommodated (bed and breakfast) from _____ to _____

Requests for accomodation: sunshinetour@sunshinetour.net

Meals.

At the expense of: The Organiser or Athletes
Meals provided from _____ to _____ .

NB: If applicable, Organiser must provide proper sanitary conditions. The showering facilities should be sufficient for both male and female grooms with hot and cold water. Shower facilities as well as restrooms should at all times be in a state of cleanliness.

XI. LOGISTICAL/ADMINISTRATIVE/TECHNICAL INFORMATION

1. DRAW

List of Draws, time, date and location: Draw will be made by computer at the Show Office the day before each class.

2. COMPETITION ARENA(S)

Dimensions: Arena 5: 75mx105m
Type of Footing: Sand

3. PRACTICE ARENA(S)

Dimensions: Arena 6: 80mx85m
Type of Footing: Sand "All weather"

Riders must have the possibility to exercise their horses in an exercise area under a Steward's supervision at least 30 minutes per day outside of the competition warm-up period. Details of opening times of exercise areas must be included in the timetable.

4. STABLES

Size of boxes 3 m x 3 m (minimum 3m x 3m+20% 3m x 4m)

5. SAFETY CUPS

Name of Manufacturer: BECK & HEUN GMBH Steinstrasse 4 D-35794 Mengerkirchen

6. TIMING DEVICE

Name of Manufacturer: ALGE
Model: TDC 8001
FEI Report number: 22020007A

7. SCORING/TIMING PROVIDER

Will you use a FEI Certified Service Provider to manage the scoring and timing at your Event?

(The list of certified Service Providers is available here: <https://inside.fei.org/fei/your-role/it-services/it-providers/list>)

No

Name of the company: CIRCUITO HÍPICO DEL SOL, S.L.

Contact person at Event

Name: Begoña Quirós Cabrera

FEI ID number: 10114813

Contact email: office@sunshinetour.net

The FEI may require to be provided with real time results data feed of your events according to FEI requirements; in this case you and your provider will be informed accordingly.

8. OTHER TECHNOLOGY/SERVICE PROVIDER(S)

Will you use other technology/service provider(s) at your event?

No

9. PRIZE GIVING CEREMONY

The owner of the winning horse/pony must be invited to the prize giving ceremony for the Grand Prix, if present at the event.

The number of athletes required to present themselves for the prize-giving ceremony of each competition is .

10. ADVERTISING ON ATHLETES AND HORSES

At CSI events, and all competitions except for the Nations Cup, athletes are authorised to carry the logo of their personal sponsor in accordance with the articles 256.3 and 257.3 of the FEI Jumping Rules.

The Chief Steward will check that the advertising on athletes and horses complies with these Articles.

11. TICKETING

Are you selling tickets for spectators to attend your event: Yes No

Name of your ticketing provider:

Web address to buy ticket:

12. BETTING

Betting will be authorised by the Organiser: Yes No

13. TRANSPORT REIMBURSEMENT HORSES / PONIES

Transport expenses to be paid by:

The Organiser at per km.

The Athlete

14. WELCOME

The time and date of arrival of athletes, horses and their means of transport must be given to the Organiser in order to facilitate their arrival.

15. LOCAL TRANSPORTATION - ARRANGEMENTS FROM HOTEL TO SHOWGROUNDS

Walking distance

Organiser Shuttle Service

Public Transport to be paid by the Organiser / the Athlete

If paid by Athlete approximate cost per round trip:

Other:

16. ENTRY RIGHT TO SHOWGROUNDS/ACCREDITED PERSONS

Entry right to the stable area according to FEI Veterinary Regulations Articles 1008-1009.

NUMBER OF ACCREDITED PERSONS:

Athlete: 1

Partner: 1

Groom: 1

Horse Owner: 2 two (2) accreditations per horse acc. to FEI-Passport

17.SUSTAINABILITY

Please consider the environment when organising an FEI Event. Please find useful information on FEI Sustainability here: <http://inside.fei.org/fei/your-role/organisers/handbook>

XII. VETERINARY MATTERS

1. CUSTOMS FORMALITIES

Contact details for Customs Formalities:

Name: TRANSHIPICA INTERNATIONAL JESUS ESTEVEZ
Address: Asunción, 15. Brunete (Madrid-Spain)
Telephone: +34 918 158 276
Fax: +34 918 158 270
Email: info@jesusestevez.com
Opening hours:

2. HEALTH REQUIREMENTS

GENERAL

In accordance with the FEI Code of Conduct for the Welfare of the Horse it is imperative that all Horses at FEI Events are physically fit and free from infectious disease before being allowed to compete.

ENTRY OF HORSES

Required health tests and vaccinations:
Quarantine period:
Specimen Import Licence applied:

For questions or problems, please contact your Government Veterinary Services.

3. NATIONAL REQUIREMENTS

If applicable please provide: UE Requirements

Absolutely necessary for Spanish Authorities:

1. Horses coming from the rest of Spain: Transport and health certificate.
2. Horses coming from EU: International Transport Certificate valid between EU members.
3. Horses coming from other countries: Valid Certificate which is required at the moment of entry.

Only for horses travelling from Spain:

CODIGO DE EXPLOTACION O REGA: ES 110390000780

Dehesa Montenmedio

Carretera Nacional 340, Km.41.3

11150 Vejer de la Frontera (Cádiz-España)

4. PONIES

FEI Veterinary Regulations, Chapter IX and Annex IX:

For all Pony Events, Ponies must be available for Pony Measurement if requested by the FEI.

5. INJURY SURVEILLANCE

FEI Veterinary Regulations, Chapter VIII:

Horses participating in FEI Events are subject to injury surveillance protocols; and in the event of fatality, a post mortem examination.

6. TRANSPORT OF HORSES

Horses must be fit to travel and be transported in suitable vehicles for the transport of horses. Any government requirements for disease testing and control must be requested well in advance, to ensure that the horse is in compliance by the time of arrival at the border of the country where the Event is taking place. Athletes, or their representatives, have the responsibility to comply with national legislation in both their country of origin and the host nation of the Event. Where necessary athletes must contact local government authorities or veterinary advisors for information regarding animal health requirements and transport legislation. Within the European Union (EU), this includes EU Council Regulation (EC) No 1/2005 concerning the protection of animals during transport within the Member States of the EU.

7. VENUE ARRIVAL INFORMATION & FITNESS TO COMPETE

7.1. PASSPORTS. FEI General Regulations Article 137

For all issues relating to FEI Horse Passports/FEI Recognition Cards please contact your National Federation.

All Horses competing at FEI Events must be registered with the FEI.

FEI Passports or FEI Recognition Cards (for those Horses with a national passport approved by the FEI) are compulsory for FEI Events.

NB: Horses entered in CIMs and in CSIP in their country of residence are not required to have an FEI Passport or FEI Recognition Card but must be properly registered with the FEI and identifiable (GRs 137.2).

Athletes who do not present a Horse’s Passport and/or Recognition Card, or one that is not correctly validated or fail to meet other passport requirements will be **subject to Sanctions in accordance with Annex VI of the FEI Veterinary Regulations** and may not be allowed to compete.

NB for Horses permanently resident in a Member State of the European Union: all Horses must have a national EU passport in compliance with EU Regulations to which a FEI Recognition card is applied. The exception to this being Horses in possession of an FEI passport which has been continually revalidated without interruption.

7.2. VACCINATIONS - EQUINE INFLUENZA. FEI Veterinary Regulations Article 1003

Horses competing at FEI Events must comply with the requirements for Equine Influenza vaccination in accordance with the Veterinary Regulations and as summarised below.

VACCINATION	PROTOCOL	ELIGIBILITY TO ENTER VENUE
Primary Course	1 st Vaccination: day 0 2 nd Vaccination: day 21-92	May compete 7 days after the 2 nd Vaccination
First Booster	Within 7 months of the 2 nd vaccination of the Primary Course	May compete for 6 months +21 days after the 2 nd vaccination of the Primary Course Must not compete in the 7 days after receiving a vaccination
Boosters	MINIMUM: within one year of previous booster vaccination IF COMPETING: must be in	Must have been vaccinated within 6 months +21 days before arriving at the Event

	the 6 months +21 days of the booster previous vaccination	Must not compete in the 7 days after receiving a vaccination
--	---	--

All FEI registered Horses intending to compete at FEI Events (including CIMs) must be vaccinated against Equine Influenza in accordance with these VRs. The exception being if the applicable domestic legislation prevents the use of Equine Influenza vaccines within the relevant territory

7.3. EXAMINATION ON ARRIVAL. FEI Veterinary Regulations Article 1031

On arrival at an Event venue, all Horses must undergo an examination by a veterinarian to confirm their identification from their passport and micro-chip ID (where present), their vaccination status and general health. To protect all horses attending events, any Horse with a questionable health status concerning vaccination, disease or other concerns, must be stabled within the isolation facilities provided by the Organising Committee pending a decision on entering the venue.

7.4. HORSE INSPECTIONS. FEI Veterinary Regulations Articles 1034-1042

All Horses will be assessed for their fitness to compete during the Horse Inspection. Any Horse demonstrating questionable fitness may be referred to the Holding Box for further veterinary examination. Horses not deemed fit to compete by the Inspection Panel will not be permitted to compete.

7.5. LIMB SENSITIVITY EXAMINATION. FEI Veterinary Regulations Articles 1048-1053

All Horses are subject to examination under the protocol for abnormal limb sensitivity throughout the period of an Event. For Jumping that includes, but is not limited to, between rounds and before the Jump Off. Horses may be examined once or on multiple occasions during the Period of an Event.

Horses may be selected for examination under the protocol randomly or they may be targeted. All Horses selected to be tested must submit promptly to the examination or are subject to immediate disqualification. There is no obligation to examine any specific number of Horses at an Event.

8. EQUINE ANTI-DOPING AND CONTROLLED MEDICATION PROGRAMME (EADCMP). FEI VETERINARY REGULATIONS, CHAPTER VII

8.1. SAMPLING. FEI VETERINARY REGULATIONS Chapter VII

All horses competing at FEI Events may be subject to sampling for the presence of Prohibited Substances in accordance with the Anti-Doping and Controlled Medication Regulations (EADCMRs). Horses may be selected for sampling in accordance with obligatory testing, targeted or random sampling procedures. Refer to FEI Financial Charges for details of fees relating to Equine and Human Anti-Doping program (EADCMP), which OCs/NFs have the right to charge to the athlete (applicable for all FEI events worldwide).

8.2. ELECTIVE TESTING. FEI VETERINARY REGULATIONS ARTICLES 1058

Elective Testing may be carried out prior to an Event to check for the presence of Prohibited Substances. Please refer to <https://inside.fei.org/fei/cleansport/horses> for information and details.

XIII. HUMAN ANTI-DOPING

Athletes can be tested at any FEI Event, by the FEI or by other Anti-Doping Organisations with Testing jurisdiction. Organisers will have the responsibility to provide facilities and staff/volunteers to facilitate such Testing if requested by the FEI as outlined in article 22.3 of the FEI's Anti-doping Rules for Human Athletes (ADRHA).

The ADRHA rules are published on the FEI website at <http://inside.fei.org/content/anti-doping-rules>.

XIV. ADDITIONAL INFORMATION

1. INSURANCES AND NATIONAL REQUIREMENTS

Equestrian sports involve inherent dangerous risks. To the greatest extent permitted by law, the FEI and the FEI Event Organiser shall NOT be liable for any damages relating to loss of property or injury of any kind to Athletes, Owners, Support Personnel or Horses at or in connection with an FEI Event and the FEI expressly excludes all such liability.

1.1. ATHLETES, OWNERS AND SUPPORT PERSONNEL

1.1.1. Personal Accident and Health Insurance

It is your responsibility as an Athlete/Owner/ Support Personnel to ensure that you have adequate personal accident insurance in place to cover your participation at FEI Events and in particular to insure against any personal injury or medical expenses arising from an accident, injury or illness which may occur at a FEI Event.

You should check with your National Federation to confirm if your National Federation's insurance policy (if any) covers personal accidents and/or illnesses which may occur when you are attending/participating in FEI Events.

If your National Federation does not have a personal accident/health insurance policy or if the National Federation's insurance policy does not cover personal accident or health claims, then you should obtain your own personal accident and health insurance policy to cover your attendance/participation at FEI Events.

1.1.2. Personal Property Insurance

You should also ensure that you are insured against property loss, theft or damage which may occur at an FEI Event.

Again, the advice is to check with your National Federation to confirm if they have an insurance policy in place which would cover you in case of such property loss, theft or damage. If not, then you should obtain your own personal property insurance to cover such situations.

1.1.3. Press Equipment

Press equipment and other items left in the Press workroom, Press lockers, the Press Tribune or anywhere on the showgrounds are left entirely at the owner's risk. The Organising Committee does not accept any responsibility for any loss or damage to such equipment or items. Members of the Press are advised not to leave any equipment or personal items unattended.

1.2. ATHLETES AND OWNERS

1.2.1. Third Party Liability Insurance

As an Athlete/Owner you are personally responsible for damages to third parties caused by you, your employees, Support Personnel, your agents or your Horses. You are, therefore, strongly advised to take out third-party liability insurance providing full coverage in relation to FEI Events at home and abroad, and to keep the policy up to date.

The FEI and the Organiser will NOT be responsible for any damage caused to third parties by you, your employees, Support Personnel, your agents or your Horses.

1.2.2. Additional Liability Information

Space for organiser to include reference to National Laws when necessary

1.2.3. Horse Insurance

As an Owner you should ensure that your Horses are adequately insured against any injuries or illnesses they may sustain while participating at a FEI Event.

2. PROTESTS/APPEALS

To be valid, all Protests and Appeals must be made in writing and accompanied by a deposit of CHF 150.- or equivalent.

Protest and appeal forms are available on the FEI website:

Protests: <http://inside.fei.org/sites/default/files/FEI%20Protest%20Form.pdf>

Appeals: <http://inside.fei.org/sites/default/files/FEI%20Appeal%20Form.pdf>

3. SCHOOLING DURING COMPETITIONS

Athletes wishing to school during speed competitions (Table A and Table C) must inform the OC before these competitions begin. These athletes will start first in these competitions.

4. STEWARDING

- If an athlete is uncertain as to whether the boots he/she intends to use during an event are allowed, he/she or his/her representative should show the boots to the Chief Steward for his/her opinion before the boots are used in training or in competition.
- In addition, athletes are to be made aware that hind boots must be removed and placed again on the horse's legs in the presence of a Steward while in the warm-up arena prior to entering the competition arena for certain competitions. (If bandages are used in place of boots, athletes are not required to remove the bandages in the warm-up arena.) This procedure is compulsory for competitions for which boot and bandage control is mandatory, that is the Nations Cup, Grand Prix, and the competition with the highest prize money, and is at the discretion of the Chief Steward for other competitions.
- As an alternative to carrying out this procedure at the time designated by the Steward an athlete may ask his/her groom to take the boots to the in-gate and place them on the horse's legs in front of the Steward prior to the combination entering the arena.
- The Steward has the authority to intervene if a boot is deemed excessively tight by instructing that the boot be removed and put on again correctly. *[Stewards are to note*

that it is normal for a horse's gait to be somewhat affected immediately after boots have been removed and re-placed.] If an athlete or his/her groom refuses to remove and re-place the boot(s) when instructed to do so by the Steward, a Yellow Warning Card will be issued to the athlete in question.

- If it is deemed impossible or unsafe to remove the hind boots in the warm-up arena prior to the combination entering the competition arena, due to an extremely excited or nervous horse, the boots of the horse in question are to be removed by the athlete/groom following the athlete's round upon leaving the arena and inspected by the Steward. This inspection may be carried out during the boot and bandage control if the boot and bandage control is carried out for the competition in question.
- This procedure does not replace boot and bandage control after completion of an athlete's round for competitions for which boot and bandage control is mandatory (refer to JRs Art. 244.1).

5. DISPUTES

In the event of any discussion concerning the interpretation of the schedule (in translated languages), the English version will be decisive.

6. MODIFICATION TO SCHEDULE

In exceptional circumstances, together with the approval of Chefs d'Equipe, host NF delegate, if any, and the Ground Jury, the Organiser may change the schedule in order to clarify any matter arising from an omission or due to unforeseen circumstances. Any such changes must be notified to all athletes and officials as soon as possible and they must be reported to the FEI Secretary General by the Technical Delegate, the President of the Ground Jury or the Foreign Judge, as applicable.

7. ADDITIONAL INFORMATION FROM THE OC

Space for organiser to include any additional information

FEI APPROVED SCHEDULE
Vejer de la Frontera 21-23 November 2020



Age of Athletes and Horses according to the Event's Category

Event's Category	Age of Athletes	Age of Horses
Olympic Games/WEG	As of 18 th year	Min 9 y.o.
Continental Championships Senior	As of 18 th year	Min 8 y.o.
Regional Championships/Games	As of 18 th year As of 16 th year if height of obstacles max.1.40m (JRs Annex IX, Art. 6.1)	Min. 8 y.o. Min. 7 y.o. if height of obstacles max. 1.40m (JRs Art. 254.1.1)
World Cup Final	As of 18 th year	Min. 9 y.o.
Nations Cup Final	As of 18 th year	Min. 8 y.o.
CSI-W1*-5*/CSIO-W1*-5* Grand Prix, World Cup, Nations Cup, Power and Skill, Derby or Competition with the highest prize money Other Competitions Other Competitions if height max. 1.40m Other Competitions if height max. 1.30m	As of 18 th year As of 16 th year with permission of their NF As of 14 th year " " As of 12 th year " "	Min. 7 y.o. Min. 7 y.o. Min. 7 y.o. Min. 7 y.o.
CSI3*-5*/CSIO3*-5* Grand Prix, Nations Cup, Power and Skill, Derby or Competition with the highest prize money Other Competitions Other Competitions if height max. 1.40m Other Competitions if height max. 1.30m	As of 18 th year As of 16 th year with permission of their NF As of 14 th year " " As of 12 th year " "	Min. 7 y.o.
CSI2* Power and Skill or Derby Grand Prix Other Competitions if height max. 1.40m Other Competitions if height max. 1.30m	As of 18 th year As of 16 th year with permission of their NF As of 14 th year " " As of 12 th year " "	Min. 6 y.o.
CSIO2* Nations Cup, Grand Prix, Power and Skill, Derby or Competition with the highest prize money Other Competitions Other Competitions if height max. 1.40m Other Competitions if height max. 1.30m	As of 18 th year As of 16 th year with permission of their NF As of 14 th year " " As of 12 th year " "	Min. 6 y.o. *
CSI1* Power and Skill or Derby Grand Prix / Other Competitions Other Competitions if height max. 1.30m	As of 18 th year As of 14 th year with permission of their NF As of 12 th year " "	Min. 6 y.o.
CSIO1* Nations Cup, Grand Prix, Power and Skill, Derby or Competition with the highest prize money Other Competitions Other Competitions if height max. 1.40m Other Competitions if height max. 1.30m	As of 18 th year As of 16 th year with permission of their NF As of 14 th year " " As of 12 th year " "	Min. 6 y.o.
CH-Y	As of 16 th year to end 21 st year	Min. 7 y.o.
CSI/CSIO-Y	As of 16 th year to end 21 st year	Min. 7 y.o.
CH-J	As of 14 th year to end 18 th year	Min. 7 y.o.
CSI/CSIO-J	As of 14 th year to end 18 th year	Min. 6 y.o.
CSI/CSIO-Ch/CH-Ch	As of 12 th year to end 14 th year	Min. 6 y.o.
CSI/CSIOP/CH-P	As of 12 th year to end 16 th year Ponies must be registered as ponies with FEI	Min. 6 y.o.
CSIU-25	As of 16 th year to end 25 th year As of 14 th year if height max. 1.40m	Min. 7 y.o.
CSIV	As of 45 th year	Min. 6 y.o.
CSIAm	As of 12 th year until end of 13 th year if competition height is max. 1.30 m; as of 14 th year if height exceeds 1.30 m.	Min. 6 y.o.
CSIYH	Per Art. 255.2	Min. 5 y.o. – Max. 8 y.o.
CH-M-YH-S	As of 18 th year or 16 year for athletes qualified with the same horse	5 y.o. / 6 y.o. / 7 y.o.

Art. 254.1.1: Horses entered for CSIO2 Events at which the Nations Cup is built to the dimensions set forth in JRs Art. 264.3 for 2* Events must be at least 6 years old; Horses entered for CSIO2* Events at which the Nations Cup is built to the dimensions set forth in JRs Art. 264.3 for 3* Events or higher must be at least 7 years old.

8. PRIZE MONEY DISTRIBUTION

Prize Money Distribution Chart 1: Prize money distribution with **25%** of prize money for the winner updated 30.01.2019

N° of starters	up to 11	12-48		49-100		101-110 declared starters		111-120 declared starters	
N° of prizes	Same as the number of starters who finish the competition	12		First 12 acc. to percentages below; extra prizes for 13 th to last*		First 16 acc. to percentages below; extra prizes for 17 th to last*		First 20 acc. to percentages below; extra prizes for 21 st to last*	
Prize money	Example: Competition prize money = 40'000.-	100% = 40'000		100% = 40'000		133% = 53'200		166% = 66'400	
		%		%		%		%	
1	All athletes who complete the competition receive prize money, to be distributed according to the percentages at right from the 1 st placed to the last placed athlete. The remaining prizes, i.e. the prizes foreseen up to 12 th place, are then distributed in descending order starting again with the 1 st placed athlete until there are no more prizes to be distributed. See examples below. 5 athletes: winner gets prize for 1 st (25%) and the other athletes get the relevant percentages down to the last athlete, i.e. 5 th place (7%). The prize for 6 th (5.5%) is then given to the winner, the prize for 7 th (4%) is given to the 2 nd placed athlete, the prize for 8 th (3%) is given to the 3 rd placed athlete, the prize for 9 th (3%) is given to the 4 th placed athlete and the prize for 10 th (2.5%) is given to the 5 th placed athlete. The prize for 11 th (2.5%) is then given to the 1 st placed athlete and the prize for 12 th (2.5%) is given to the 2 nd placed athlete. 10 athletes: winner gets prize for 1 st (25%) and 11 th (2.5%), second placed gets prize for 2 nd (20%) and 12 th (2.5%); the remaining athletes receive the prize money for their placing as per the percentages from 3 rd to 10 th place.	25	10'000	25	10'000	25	13'300	25	16'600
2		20	8000	20	8000	20	10'640	20	13'280
3		15	6000	15	6000	15	7980	15	9960
4		10	4000	10	4000	9	4788	8	5312
5		7	2800	7	2800	6.5	3458	6	3984
6		5.5	2200	5.5	2200	5	2660	4.5	2988
7		4	1600	4	1600	3.5	1862	3	1992
8		3	1200	3	1200	2.5	1330	2.5	1660
9		3	1200	3	1200	2.5	1330	2.5	1660
10		2.5	1000	2.5	1000	2	1064	2	1328
11		2.5	1000	2.5	1000	2	1064	2	1328
12		n/a	2.5	1000	2.5	1000	2	1064	2
Total	40'000	100%	40'000	100%	40'000				
13						1.5	798	1.5	996
14						1.5	798	1.5	996
15						1	532	1	664
16						1	532	1	664
Total						100%	53'200		
17								1	664
18								0.5	332
19								0.5	332
20								0.5	332
Total								100%	66'400
									Extra prizes for 21 st to last place*

* The OC must provide additional prizes for the remaining placed athletes to fulfil quota of one prize per four athletes. The amount to be given to each of these athletes must be stated in the Schedule.

Prize Money Distribution Chart 2: Prize money distribution with **33%** of prize money for the winner updated 30.01.2019

N° of starters	up to 11	12-48		49-100		101-110 declared starters		111-120 declared starters	
N° of prizes	Same as the number of starters who finish the competition	12		First 12 acc. to percentages below; extra prizes for 13 th to last*		First 16 acc. to percentages below; extra prizes for 17 th to last*		First 20 acc. to percentages below; extra prizes for 21 st to last*	
Prize money	Example: Competition prize money = 40'000.-	100% = 40'000		100% = 40'000		133% = 53'200		166% = 66'400	
		%		%		%		%	
1	All athletes who complete the competition receive prize money, to be distributed according to the percentages at right from the 1 st placed to the last placed athlete. The remaining prizes, i.e. the prizes foreseen up to 12 th place, are then distributed in descending order starting again with the 1 st placed athlete until there are no more prizes to be distributed. See examples below. 5 athletes: winner gets prize for 1 st (25%) and the other athletes get the relevant percentages down to the last athlete, i.e. 5 th place (7%). The prize for 6 th (5.5%) is then given to the winner, the prize for 7 th (4%) is given to the 2 nd placed athlete, the prize for 8 th (3%) is given to the 3 rd placed athlete, the prize for 9 th (3%) is given to the 4 th placed athlete and the prize for 10 th (2.5%) is given to the 5 th placed athlete. The prize for 11 th (2.5%) is then given to the 1 st placed athlete and the prize for 12 th (2.5%) is given to the 2 nd placed athlete. 10 athletes: winner gets prize for 1 st (25%) and 11 th (2.5%), second placed gets prize for 2 nd (20%) and 12 th (2.5%); the remaining athletes receive the prize money for their placing as per the percentages from 3 rd to 10 th place.	33	13'200	33	13'200	33	17'556	33	21'912
2		20	8000	20	8000	19.5	10'374	19.5	12'948
3		15	6000	15	6000	14.5	7714	14.5	9628
4		10	4000	10	4000	9.5	5054	8.5	5644
5		6	2400	6	2400	5.5	2926	5	3320
6		4.5	1800	4.5	1800	4	2128	3.5	2324
7		3	1200	3	1200	2.5	1330	2.5	1660
8		2.5	1000	2.5	1000	2	1064	2	1328
9		2	800	2	800	2	1064	2	1328
10		2	800	2	800	2	1064	2	1328
11		1	400	1	400	1	532	1	664
12		n/a	1	400	1	400	1	532	1
Total	40'000	100%	40'000	100%	40'000				
13						1	532	1	664
14						1	532	1	664
15						1	532	1	664
16						0.5	266	0.5	332
Total						100%	53'200		
17								0.5	332
18								0.5	332
19								0.5	332
20								0.5	332
Total								100%	66'400
									Extra prizes for 21 st to last place*

* The OC must provide additional prizes for the remaining placed athletes to fulfil quota of one prize per four athletes. The amount to be given to each of these athletes must be stated in the Schedule.

In case of a tie for the 12th place in a competition with 12 to 48 starters, the prize money foreseen for the 12th place will be divided equally among the athletes concerned.

For Competitions run in two rounds with more than 12 starters in 2nd round:

OCs that indicate in the schedule that a specific number (that is more than 12) of athletes will return for the second round will be permitted to distribute the prize money for that competition among all the athletes taking part in the second round, even if the second round is followed by a jump-off in case of a tie on penalties for first place after the second round.

DEDUCTIONS FROM PRIZE MONEY AT COMPETITIONS:

Full details of any deductions from prize money must be outlined in the schedule. This includes government taxes. If it is necessary for Organisers to deduct such taxes, they must provide participants with an official form indicating the amount of tax deducted.

The tax form must be provided to the athletes upon arrival and returned to the Organiser prior to departing.

According to the Spanish Law concerning Physical Person Return Tax (I.R.P.F), the OC must deduct the rate fixed by the above-mentioned law over all the sums paid to the competitors. This rate differs according to the athletes nationality. It depends on the international agreements established by Spain with the different European countries. Currently, the tax rate (I.R.P.F) for Foreign Competitors is 24%.

All riders may ask for further information to:

MINISTERIO DE ECONOMIA Y HACIENDA
Delegación de Hacienda de Madrid
c/ Guzman El Bueno, 73
28015 MADRID (ESPAÑA)

Prize money is including 21% VAT.

IMPORTANT

The total amount of prize money shown for each Competition in the schedule must be distributed. (FEI General Regulations articles 127 and 128)

For details of the prize money breakdown for each competition please refer to the tables at the end of this document; the Organiser must specify which of the two (2) tables will be used. The total prize money for the Competition must be distributed among the first twelve (12) placed athletes.

The Organiser must provide additional created prizes for athletes placed beyond twelfth (12th) place. The minimum amount for each of these additional prizes, for athletes placed from thirteenth (13th) to last place, must be clearly specified in the approved schedule and not exceed the prize money of the athlete placed twelfth (12th)

9. MAXIMUM NUMBER OF STARTERS PER COMPETITION

***Annex VI FEI Jumping Rules:**

Maximum 100 starters per Competition other than the GP. If more than 100 starters are declared, the OC must provide the following percentages of additional prize money for every ten declared starters, up to 120 declared starters:

- 101 to 110 declared starters: the OC must provide 133% of the original Competition prize money, which is to be distributed among the 16 best placed athletes in the Competition according to the prize money distribution chart I or II. The additional prize money provided by the OC is not taken into consideration with regard to the overall prize money that determines the star level of the Event or the Longines Ranking point group of the Competition, if applicable.
- 111 to 120 declared starters: the OC must provide 166% of the original Competition prize money, which is to be distributed among the 20 best placed athletes in the Competition

according to the prize money distribution chart I or II. The additional prize money provided by the OC is not taken into consideration with regard to the overall prize money that determines the star level of the Event or the Longines Ranking point group of the Competition, if applicable.

If more than 120 starters are declared, the OC must split the Competition into two groups and provide 200% of the original Competition prize money which is to be divided equally between the two groups. The additional prize money provided by the OC is not taken into consideration with regard to the overall prize money that determines the star level of the Event or the Longines Ranking point group of the Competition, if applicable.

OCs may apply either of the following methods for splitting the Competition:

The competition is split into two groups before it starts. There may be athletes with multiple horses in each group but all horses of any one athlete must be in the same group. If it is not possible to have two groups of equal size there may be a different number of starters in each group;

OR

The competition is run as one single competition and split afterward into two groups and the classification established as follows: the athlete with the best score is the winner of the first group, the athlete with the second best score is the winner of the second group and so on until prizes have been allocated to 25% of the total number of starters. *NB: In this case separate results must be sent to the FEI for each of the two groups, e.g. results for Competition 1a and for Competition 1b.*

In both cases above each group must offer the same amount of prize money. For the avoidance of doubt, it is the number of declared starters in the Competition, not the final number of starters, that determines whether the Competition must be split.

If there are more than 200 declared starters, the OC must split the Competition into three groups and provide the same percentages of additional prize money as indicated above (100% of original Competition prize money to be provided for each of the three groups if each group has 100 or fewer starters; 133% of original prize money to be provided for each group if any of the three groups has 101-110 starters; 166% of original prize money to be provided for each if any of the three groups has 111-120 starters).

³ For CSI-W Events with a Grand Prix Competition in addition to the FEI World Cup™ competitions, the minimum prize money requirements indicated above for the Grand Prix apply only to the FEI World Cup™ Competition as it has the status of a Grand Prix; the Grand Prix Competition at such Events cannot offer more prize money than the prize money offered for the FEI World Cup™ Competition. Refer to the FEI Jumping World Cup™ rules for details relating to date of implementation of this rule at CSI-W Events.

10. GLOSSARY

***Glossary FEI Jumping Rules:**

Fees:

- Compulsory Fee: Compulsory Fees are fees that may be charged by the OC for costs/services not included in the Entry Fee. Compulsory Fees, if charged, must be paid by the Athletes concerned as outlined below. Only the following Compulsory Fees may be charged by the OC, providing full details of the amount to be charged is included in the Schedule and approved by the FEI:
 - NF fee if applicable
 - NF medication control programme fee if applicable
 - FEI EADCMR fee if applicable (OC to indicate in the Schedule if the EADCMR fee is included in the Entry Fee or not)
 - Fee for health/customs-related documents for Horses if these have been requested by the Athlete.
 - Fee for manure disposal (maximum € 40 per horse per Event)

- Fee for lorry parking if applicable (The fee indicated in the Schedule may only be charged per lorry not per Athlete.)
- Fee for electric hook-up for lorry (The fee indicated in the Schedule may only be charged per lorry, not per Athlete.)
- Discretionary Fee: Discretionary Fees are fees that may be charged for optional commodities/services that may be purchased by an Athlete if he so chooses and that do not affect the equity of the Athlete's right to compete at the Event or the well-being of the Horse, such as:
 - VIP or premium parking
 - VIP table
 - Extra box for tack or for non-competing Horse
 - Extra bedding and/or fodder (details to be included e.g. shavings, straw, hay)
 - Premium stabling (all stabling at the Event must meet minimum FEI requirements)
- Entry Fee: The Entry Fee is the fee charged to participate in an Event with one Horse and covers the following:
 - Stabling of one Horse for the duration of the Event (includes cleaning and disinfecting stables before the event, including between Events that are part of Tours, water and electricity in the stables, first bedding or a fixed amount of bedding depending on the type of event and 24 hour security services for the stables)
 - Use of all facilities at the Event (no infrastructure fees may be charged)
 - Right to participate in all Competitions in accordance with the conditions in the Schedule (no nomination fees or start fees may be charged)
 - Administrative/Office fees (includes all services relating to administration of the Event and running of the Competitions: data/results/timing services, bookkeeping and accreditation services)

XV. ANNEXES

1. FEI ENTRY SYSTEM

Please fill the form below in order to provide you and the other members of your committee or your IT Providers access to the FEI Entry System.

FEI ID¹: 10006341
Name*: Teresa
First Name*: Blázquez Abascal
E-Mail*: info@sunshinetour.net
Access Rights*: Admin² Consult³
Events⁴:

FEI ID¹: 10114813
Name*: Begoña
First Name*: Quirós Cabrera
E-Mail*: office@sunshinetour.net
Access Rights*: Admin² Consult³
Events⁴:

FEI ID¹:
Name*:
First Name*:
E-Mail*:
Access Rights*: Admin² Consult³
Events⁴:

¹ If already have an FEI user account.

² Provides you the required access to manage entries and substitutions and download entries/lists.

³ You are just able to consult and download the entries/lists.

⁴ Leave the field blank if the user deals with the entries of all events in the show.

* **Mandatory Fields**

2. RESULTS

In order to proceed with the results publication and for qualification purposes the FEI requires results **to be uploaded directly on the FEI Database** within two days after the conclusion of the event.

All relevant information, file format and tutorial can be found on this page:

<http://inside.fei.org/fei/your-role/organisers/xml-format>

If you or your provider are unable to produce the required files, results will be accepted by e-mail to results@fei.org, in the proper Excel or "XML" format immediately after the event.

Please refer to compulsory format for CSIs/CSIOs/Championships and Games; the file can be downloaded using the following link:

<https://inside.fei.org/fei/your-role/it-services/results/jumping-results-forms>

All results must include FEI Passport Registration number of horses and FEI ID number of Riders.

Please note that as per Art. 109.6 (GR): OCs of International Jumping Events must inform the FEI and NFs whose teams or individuals have taken part, of the results and prize money paid to each placed Athlete and team, within two (2) days following the Event, unless otherwise specified for qualification and ranking reasons as communicated by the FEI. Failure from OCs of International Events to provide the FEI with the appropriate result(s) and/or prize money information by the aforesaid deadline and/or in the aforesaid format shall entail a warning for the first violation and thereafter a fine of CHF 1'000.- per violation.

THE APPENDIX (8 PAGES) IS PART OF THIS APPROVED AND SIGNED SCHEDULE AND MUST BE DISTRIBUTED TO ALL OFFICIALS AND NFs AND IS AVAILABLE TO OTHERS UPON REQUEST